

TP-3640-KH·PH series [For intermittent operation]

Output[w] **5.3~9.3**

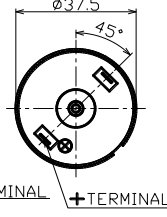

4-M3×0.5 TAPPED HOLE
(3.5mmMAX) P.C.D#31

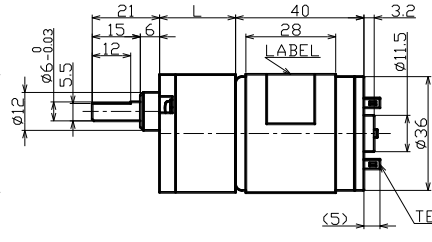
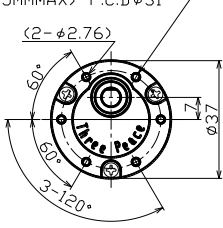

Gear ratio	1/5~1/900
Torque[mN·m]	39.2~588
Speed[r/min]	1,314~5.4
Voltage[V]	12 · 24

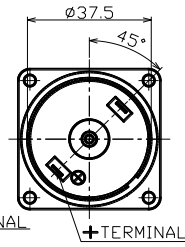
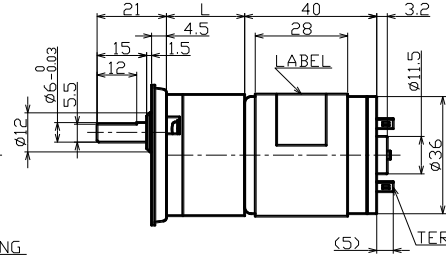
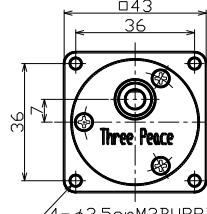
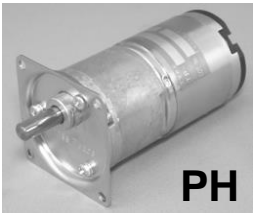

Unit[mm]

TP-3640-KJ·PJ series [For endurance run]

Output[w] **5.3~9.3**

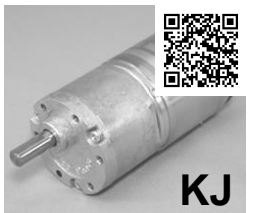

4-M3×0.5 TAPPED HOLE
(3.5mmMAX) P.C.D#31

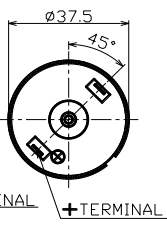
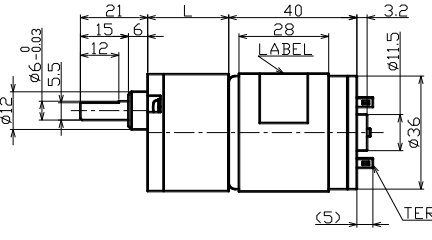
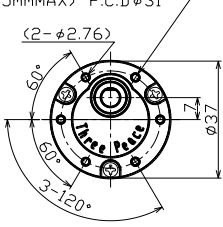

Gear ratio	1/5~1/900
Torque[mN·m]	39.2~588
Speed[r/min]	1,314~5.4
Voltage[V]	12 · 24

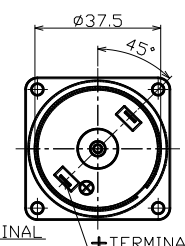
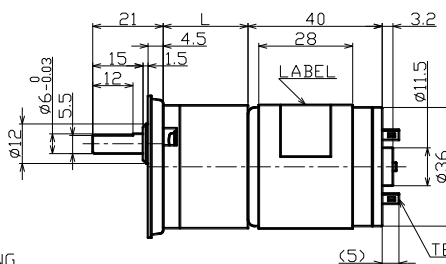
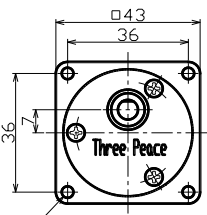
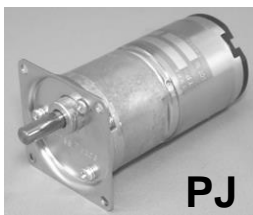

Unit[mm]

TP-3640-KS·PS series [For intermittent operation • Sintering gear]

Output[w] **5.3~9.3**



4-M3×0.5 TAPPED HOLE
(3.5mmMAX) P.C.D#31

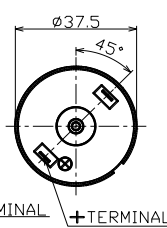
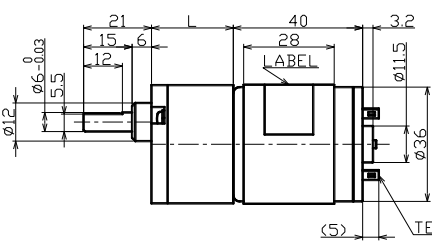
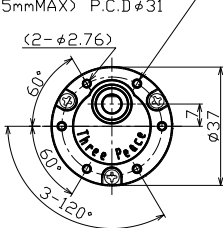

Gear ratio	1/10~1/900
Torque[mN·m]	98~588
Speed[r/min]	597~5.4
Voltage[V]	12 · 24

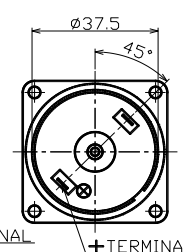
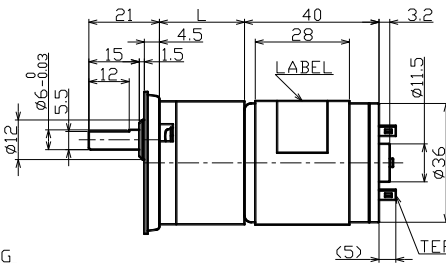
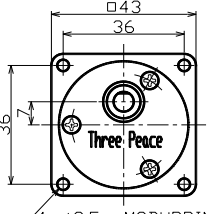

Unit[mm]